

HILLCREST AVENUE

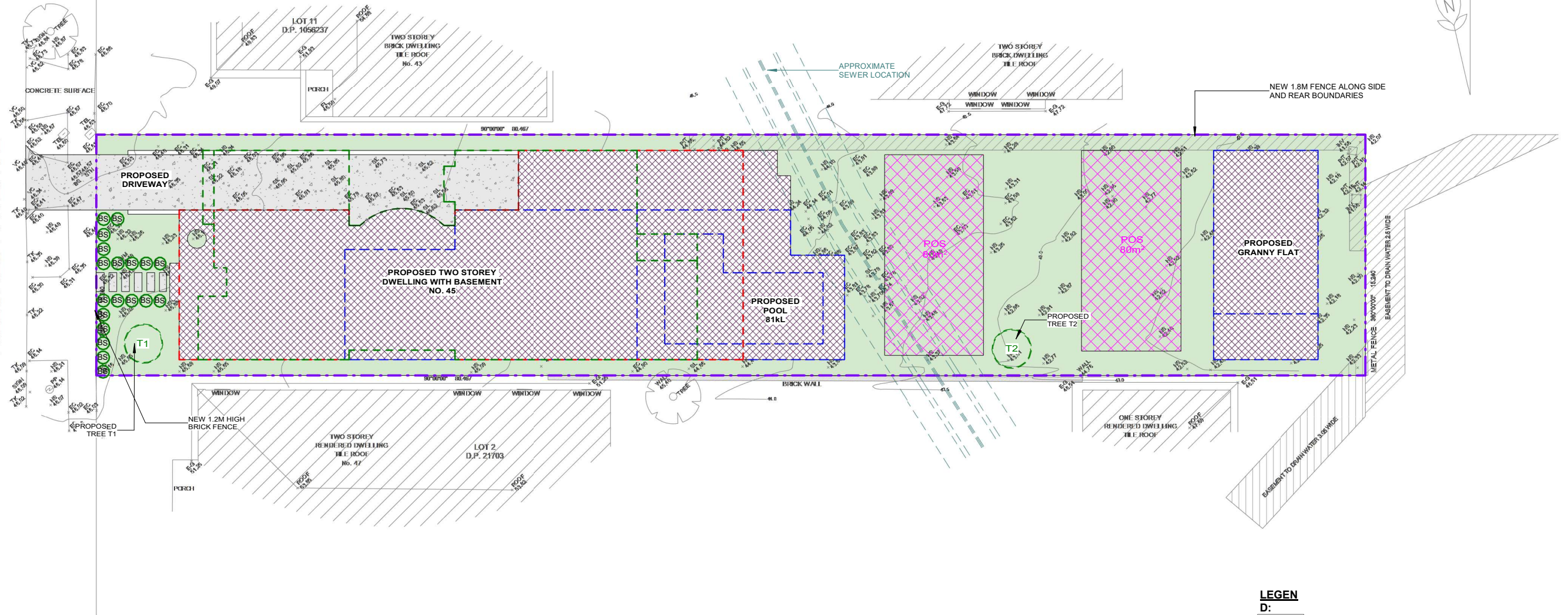

2. Minimum soil standards for plant sizes are provided in accordance with the Table below.

Tree Size	Height	Spread	Min Soil Area	Min soil depth
Large trees	>12m	>8m	10 x 10m	1200mm
Medium trees	8-12m	4-8m	6 x 6m	1000mm
Small trees	5-8m	<4m	3.5 x 3.5m	800mm
Shrubs	-	-	n/a	500-600mm
Groundcover	-	-	n/a	300-450mm
Turf	-	-	n/a	200mm

PLANTING SCHEDULE				
SYMBOL	BOTANICAL NAME	COMMON NAME	MATURE SIZE	TYPE
BS	BURSARIA SPINOSA	BLACKTORN	1M	TREE
T1	ACACIA BINERVIA	MYALL WATTLE	5M	TREE

LEGEN

D: SITE BOUNDARY

PROPOSED DWELLING

PROPOSED DRIVEWAY & CONCRETE AREAS

PROPOSED LANDSCAPING

POS 80m<sup>2</sup>

BS PROPOSED SHRUB  
Bursaria Spinosa (Blacktorn) 1m

T1-2 PROPOSED TREE  
ACACIA BINERVIA (Myall Wattle) 5m  
SIZE: MIN. 75 LTR

1 LANDSCAPING PLAN  
1 : 200

REV	DATE	DESCRIPTION	BY
A	20.05.2024	ISSUED FOR DA	DK

**COPYRIGHT**  
All rights reserved.  
These drawings, plans and specifications  
and the copyright are the property of  
Nemco Design and must not be used,  
reproduced or copied wholly or in part  
without the written permission of Nemco  
Design.

**NEMCO DESIGN**  
Pty Ltd  
STRUCTURAL ENGINEERING  
& ARCHITECTURAL DESIGN

ADDRESS:  
SUITE 4 LEVEL 1,  
402-410 CHAPEL RD, BANKSTOWN,  
NSW 2205  
P: 9759 5566 M: 0422 606 228  
E: alishah@nemco.design.com.au

**PROPOSED TWO STOREY DWELLING WITH  
BASEMENT, POOL & SECONDARY  
Dwelling 1 and  
45 HILLCREST AVE, GREENACRE  
LOT 1, DP 21703**

LANDSCAPING PLAN

JOB NUMBER:	DWG NUMBER:	ORIGINAL SIZE:
23611	A01.04	A2
DESIGNED BY:	DATE:	
A.N.	10.05.2024	
DRAWN BY:	SCALE:	
A.N.	AS SHOWN	



22/05/2024 10:56:12 AM